

Letterkenny Active Travel Project

Scheme 06 – Kilmacrennan Road

Part VIII Planning Drawings Pack

December 2023

Donegal County Council,
County House, Lifford,
Co. Donegal



**Comhairle Contae
Dhún na nGall**
Donegal County Council



An Roinn Iompair
Department of Transport



PRELIMINARY DESIGN

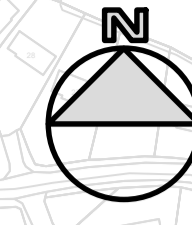
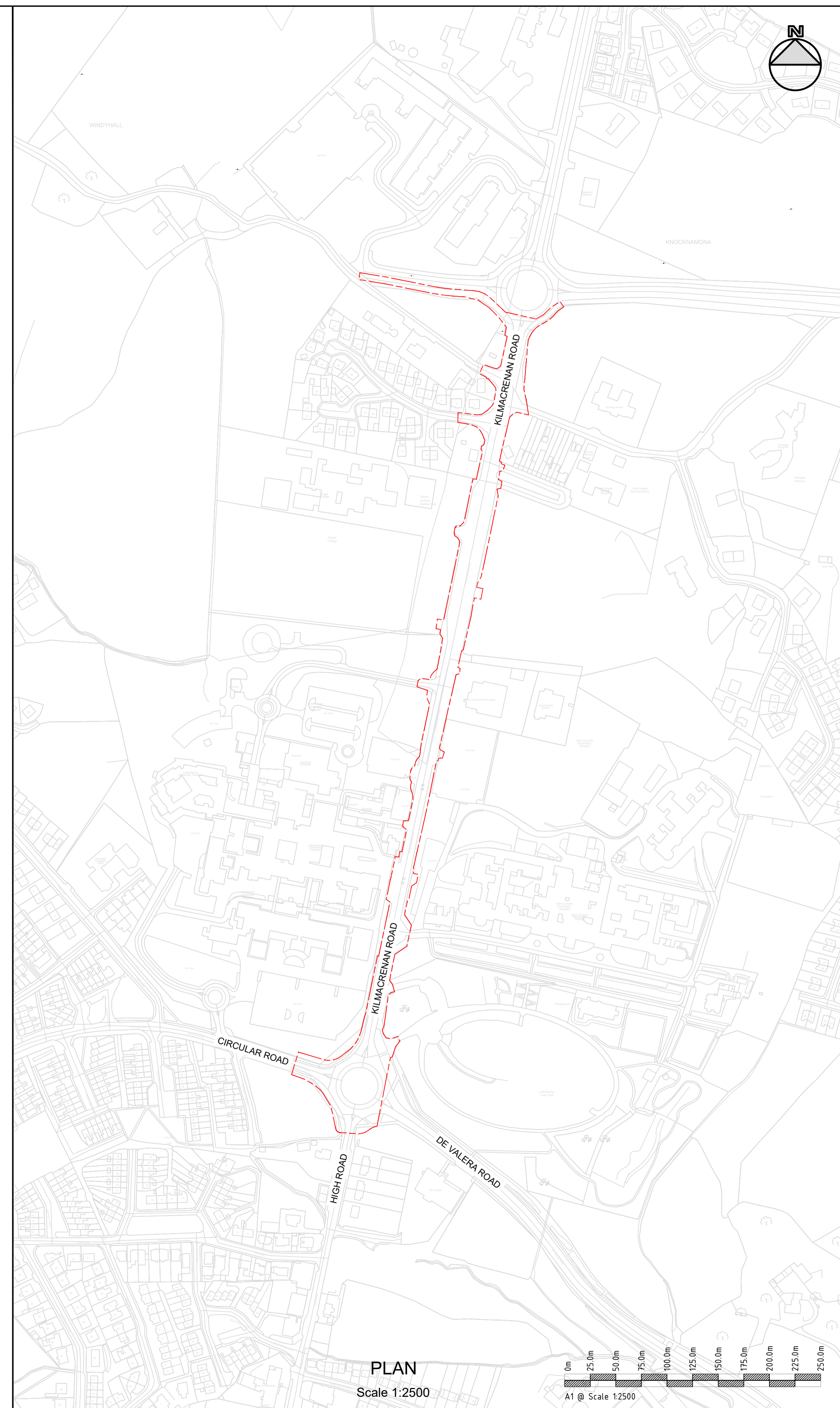
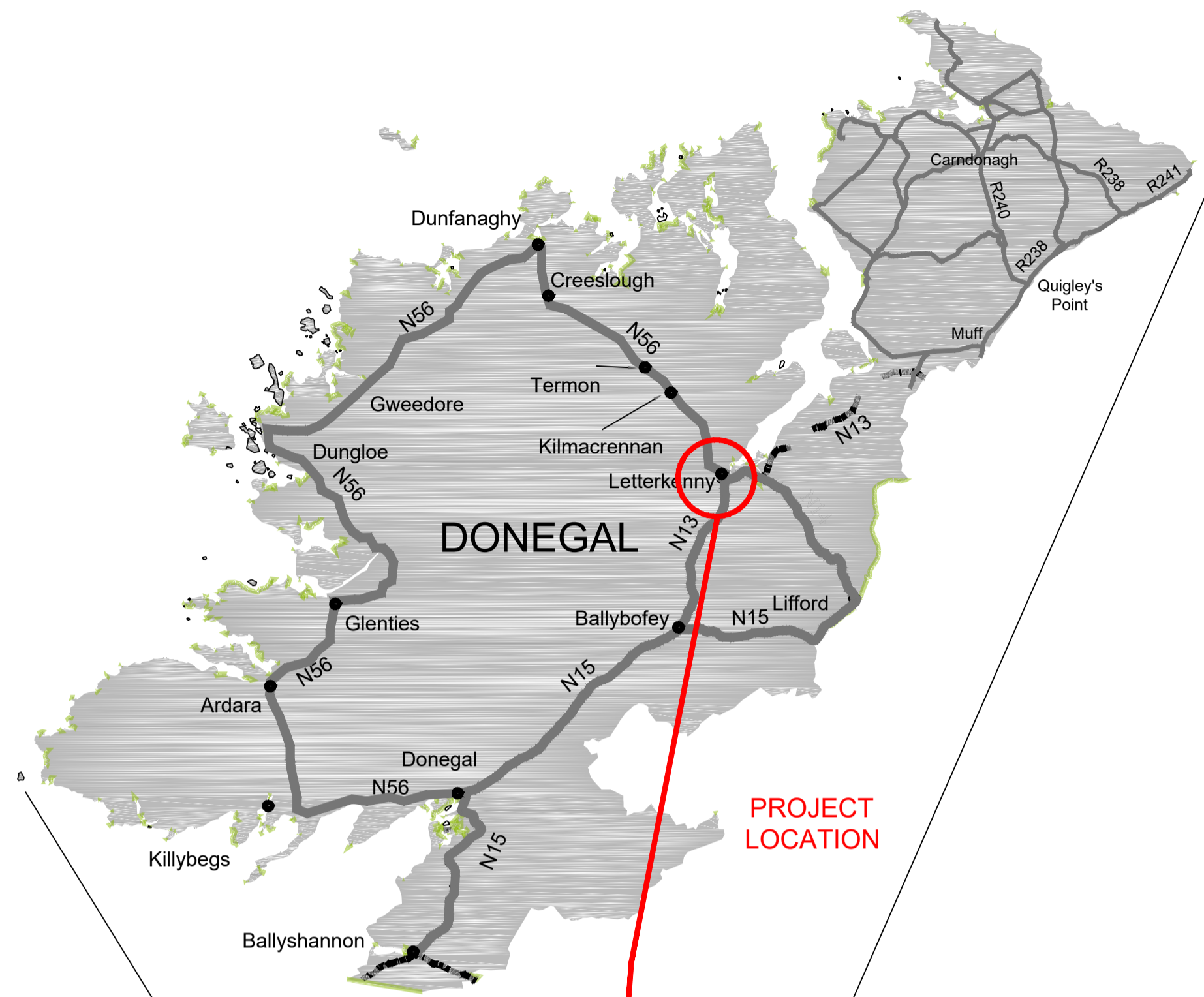

NOTES

1. This drawing is the property of Clandillon Civil Consulting. This drawing should not be relied on or used in circumstances other than those for which it was originally prepared and for which Clandillon Civil Consulting was commissioned.
2. All dimensions are in meters unless otherwise specified.

LEGEND

--- PROJECT LOCATION

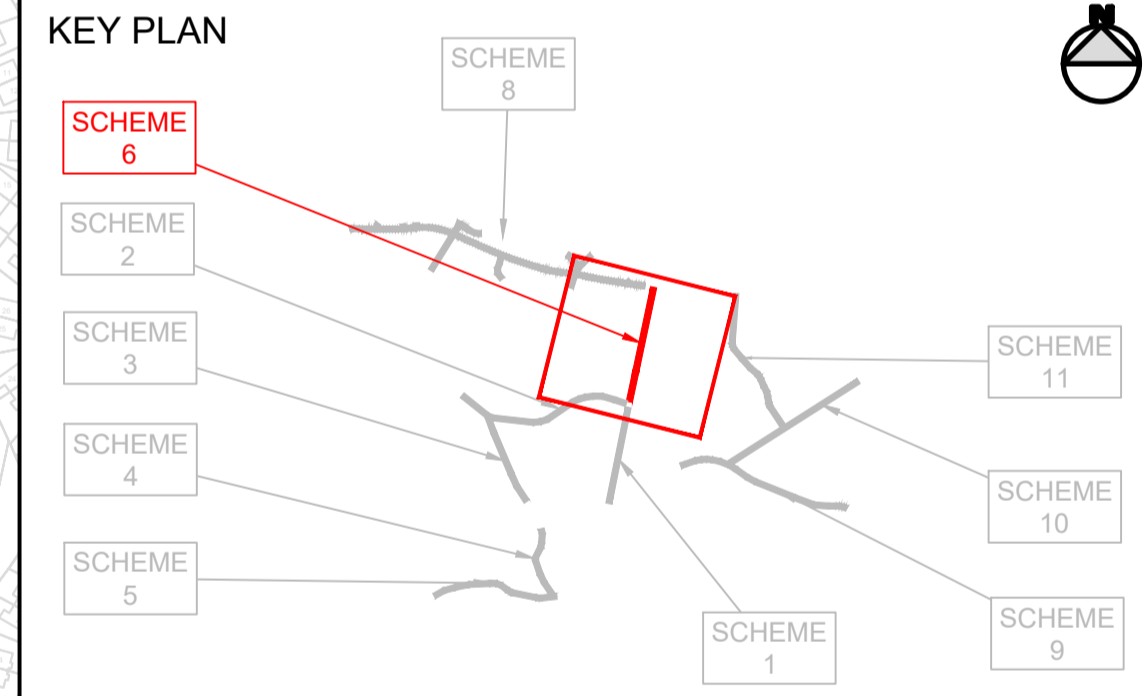

REV	DATE	DESCRIPTION	BY	CHK	APD
P01	30/11/2023	PRELIMINARY - BOUNDARY EXTENDED	YC	RB	MMK
P00	23/11/2023	PRELIMINARY	YC	RB	MMK



PROJECT
LETTERKENNY ACTIVE TRAVEL

SCHEME
SCHEME 6

DRAWING TITLE
PROJECT LOCATION & EXTENTS
KILMACRENNAN ROAD

PURPOSE OF ISSUE PRELIMINARY	STATUS/SUITABILITY S3 - SUITABLE FOR REVIEW AND COMMENT	SHEET SIZE A1
DATE 23/11/2023	SCALE AS SHOWN	REVISION P01

PLAN
Scale 1:2500

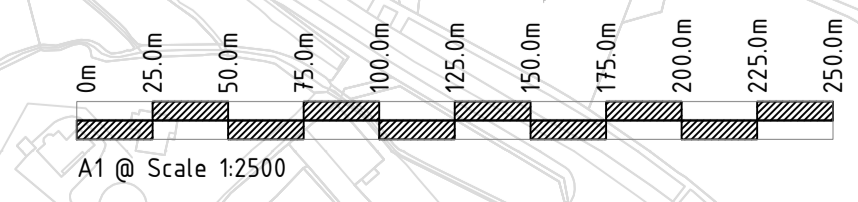

DRAWING NUMBER
LKAT-CCC-GA-L06-DR-C-0000

PRELIMINARY DESIGN

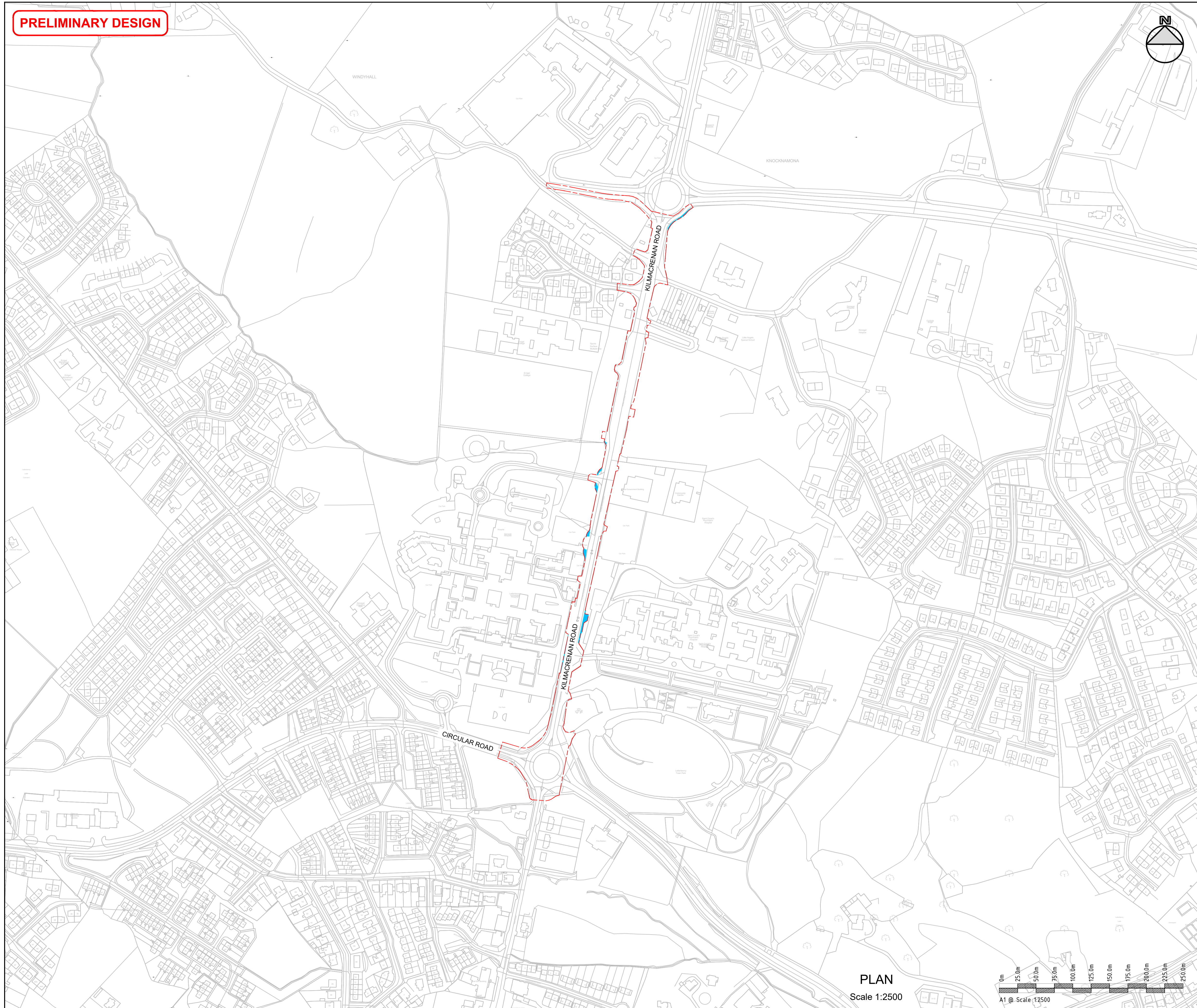
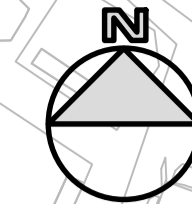

NOTES

1. This drawing is the property of Clandillon Civil Consulting. This drawing should not be relied on or used in circumstances other than those for which it was originally prepared and for which Clandillon Civil Consulting was commissioned.
2. All dimensions are in meters unless otherwise specified.

LEGEND

- BOUNDARY LINE
- ADDITIONAL LAND REQUIREMENTS

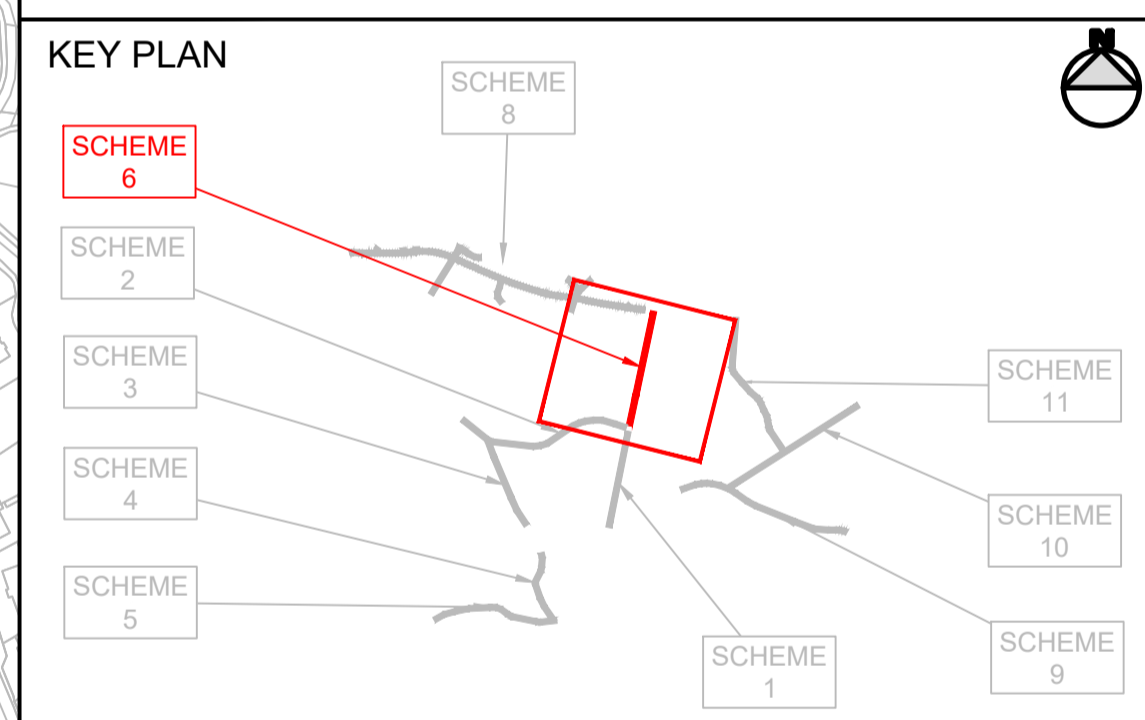

REV	DATE	DESCRIPTION	BY	CHK	APD
P01	30/11/2023	ISSUED FOR CLIENT REVIEW	YC	RB	MMK
P00	23/11/2023	PRELIMINARY	YC	RB	MMK



PROJECT
LETTERKENNY ACTIVE TRAVEL

SCHEME
SCHEME 6

DRAWING TITLE
SCHEME EXTENT
KILMACRENNAN ROAD

PURPOSE OF ISSUE PRELIMINARY	STATUS/SUITABILITY S3 - SUITABLE FOR REVIEW AND COMMENT	SHEET SIZE A1
DATE 23/11/2023	SCALE AS SHOWN	REVISION P01
DRAWING NUMBER LKAT-CCC-LA-L06-DR-C-0001		

PLAN
Scale 1:2500

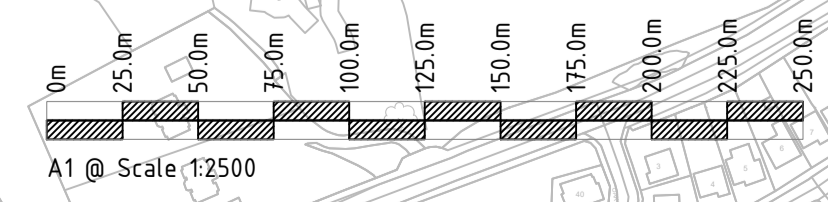

PART 8 PLANNING

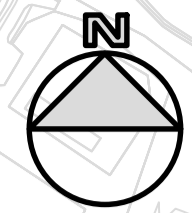
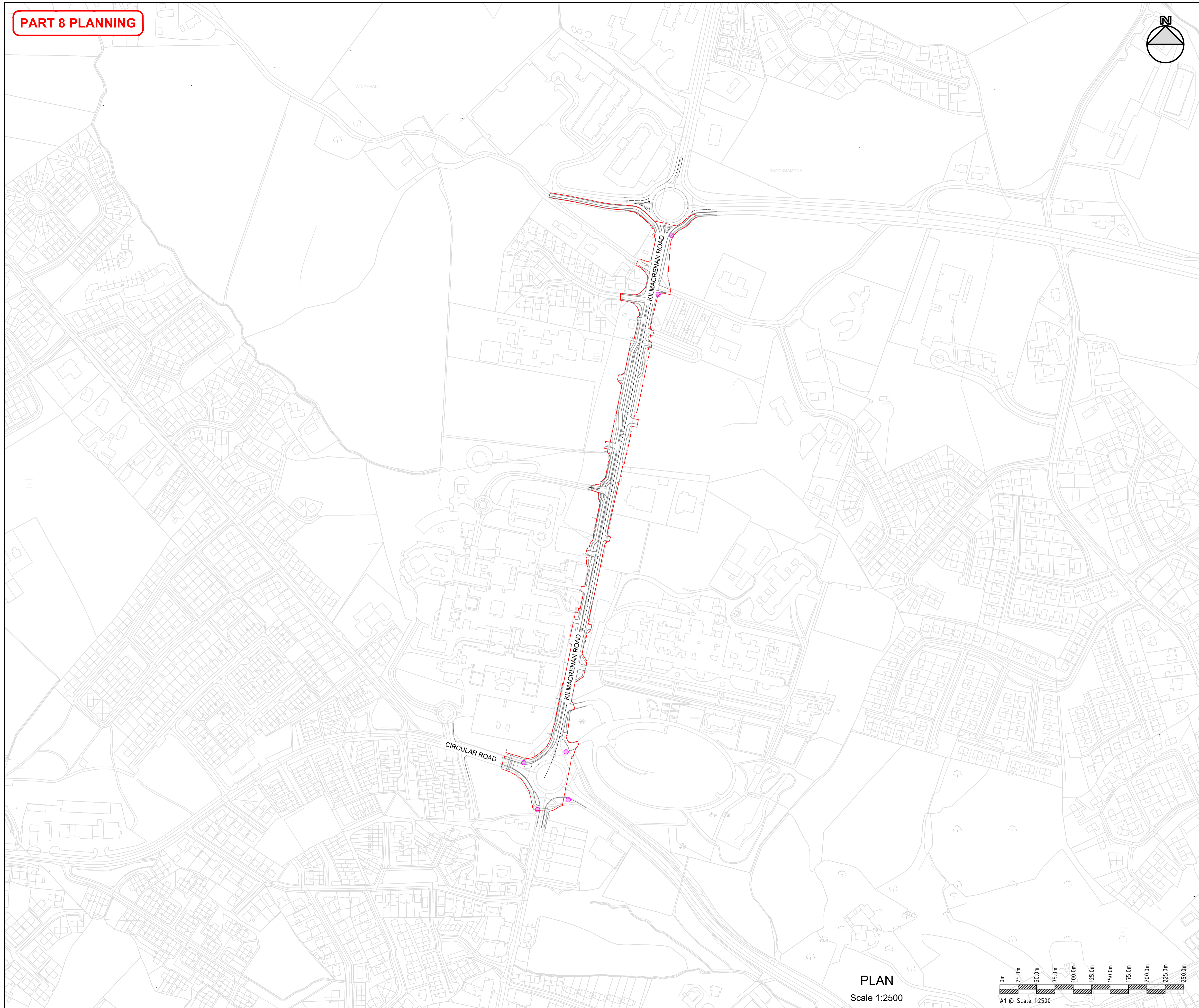

NOTES

1. This drawing is the property of Clandillon Civil Consulting. This drawing should not be relied on or used in circumstances other than those for which it was originally prepared and for which Clandillon Civil Consulting was commissioned.
2. All dimensions are in meters unless otherwise specified.

LEGEND

- CENTRELINE
- EDGE OF CARRIAGEWAY
- BOUNDARY LINE
- LAND OWNERSHIP BOUNDARIES
- SITE NOTICE LOCATIONS

KEY PLAN

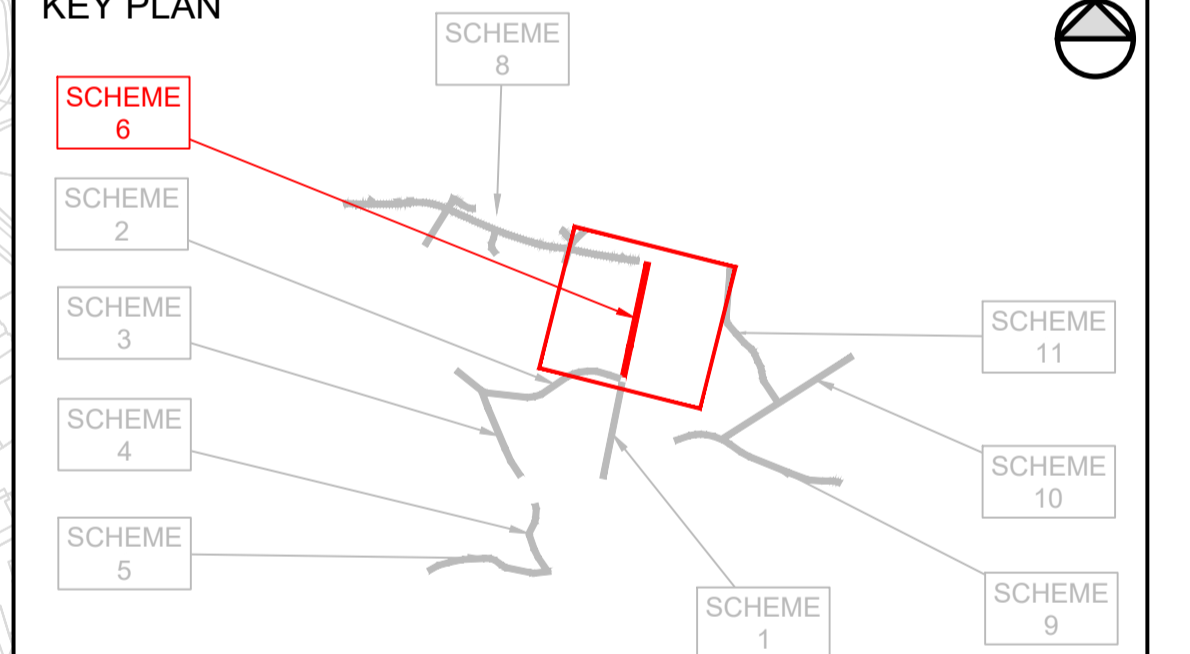

REV	DATE	DESCRIPTION	BY	CHK	APD
P01	12/12/2023	SITE NOTICE LOCATIONS ADDED	YC	RB	MMK
P00	05/12/2023	PLANNING	YC	RB	MMK

CONSULTANT

CLIENT

PROJECT: LETTERKENNY ACTIVE TRAVEL
 SCHEME: SCHEME 6

DRAWING TITLE: SITE NOTICE LOCATION
 KILMACRENAN ROAD

PURPOSE OF ISSUE	STATUS/AVAILABILITY	SHEET SIZE
PLANNING	P1-PLANNING	A1
DATE	SCALE	REVISION
05/12/2023	AS SHOWN	P01
DRAWING NUMBER		
LKAT-CCC-LA-L06-DR-C-0002		

PLAN
 Scale 1:2500

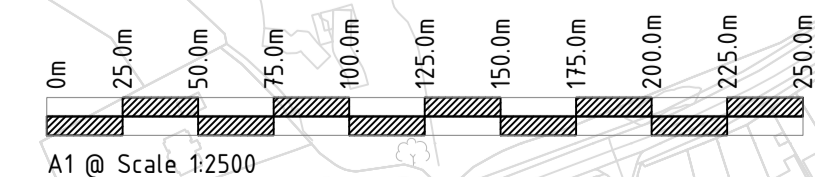

PRELIMINARY DESIGN

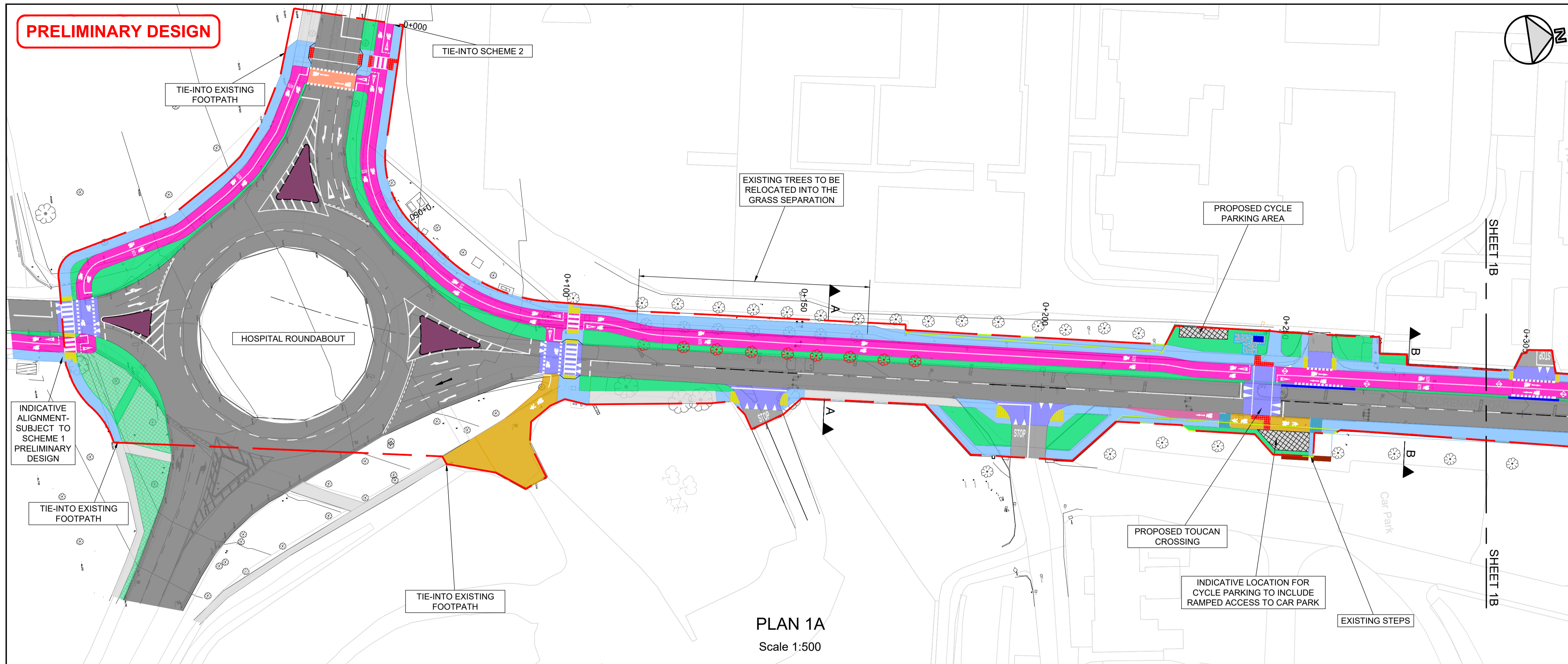

PLAN 1A
Scale 1:500

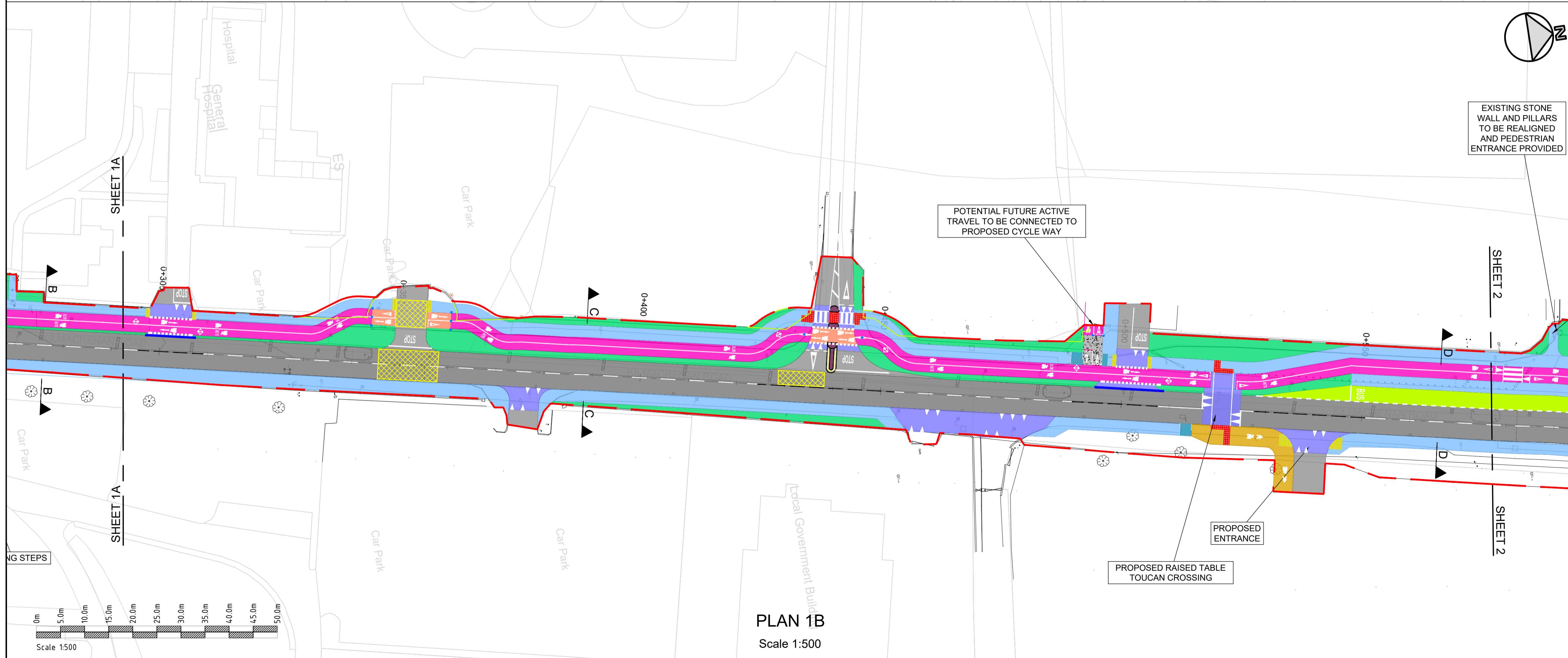

PLAN 1B
Scale 1:500

NOTES

- This drawing is the property of Clandillon Civil Consulting. This drawing should not be relied on or used in circumstances other than those for which it was originally prepared and for which Clandillon Civil Consulting was commissioned.
- All dimensions are in meters unless otherwise specified.

LEGEND

	BOUNDARY LINE
	ROAD CENTRELINE
	ROAD EDGE
	RAMP OUTLINE
	ADDITIONAL LAND REQUIREMENT
	2 WAY RAISED CYCLE LANE
	1 WAY CYCLE TRACK
	ON-ROAD CYCLE LANE
	SHARED USE PEDESTRIAN AND CYCLISTS FACILITY
	NEW / UPGRADED FOOTPATH
	EXISTING FOOTPATH TO BE RETAINED
	CONCRETE SHARED SURFACE
	BUS SET DOWN AREA
	GRASSED AREA
	SIDEROAD PAVEMENT
	ENTRANCE RAMP ADJUSTED TO FOOTWAY LEVEL
	MAINLINE CARRIAGEWAY PAVEMENT
	PAVED ISLAND/MEDIAN AREA
	OVERRUN AREA WITH ROUGHENED SURFACE
	ENTRANCE RAMP KERB
	RETAINING WALL
	CONTROLLED CROSSING TACTILE
	UNCONTROLLED CROSSING TACTILE
	CORDUROY PAVING
	CYCLISTS PARKING AREA
	BENCH
	EXISTING TREE TO BE REPLANTED
	EXISTING GRASS TO BE RETAINED

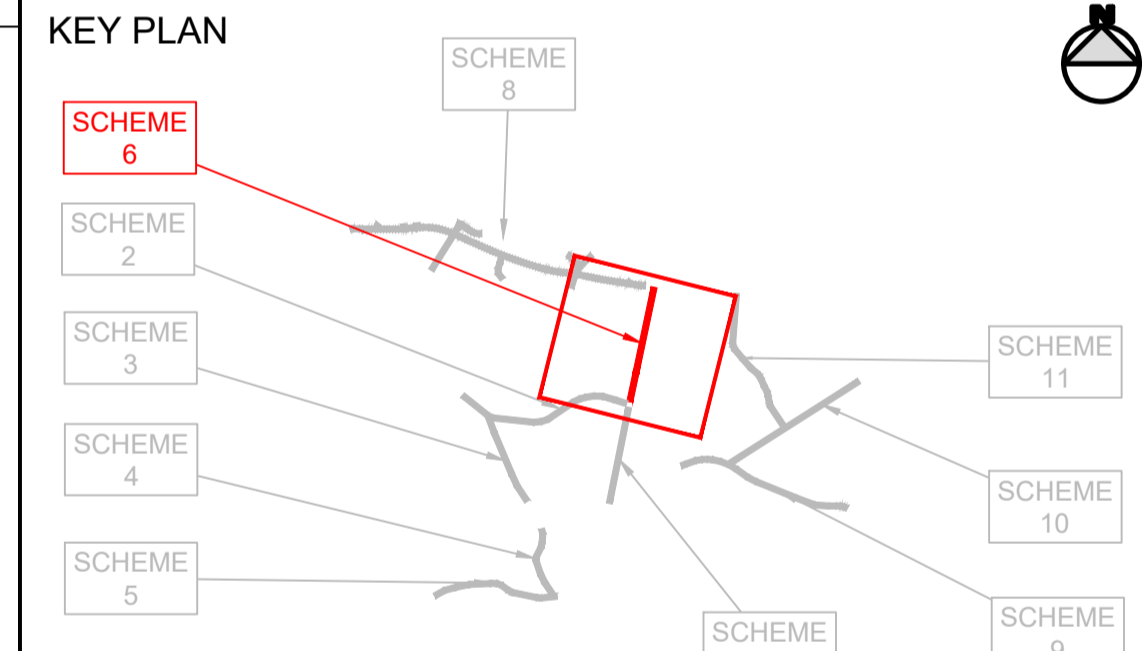

REV	DATE	DESCRIPTION	BY	CHK	APD
P03	30/11/2023	PRELIMINARY - CHANGES AS PER DCC COMMENTS	YC	RB	MMK
P02	31/10/2023	PRELIMINARY - CHANGES AS PER DCC COMMENTS	YC	RB	MMK
P01	03/10/2023	PRELIMINARY - CHANGES AS PER DCC COMMENTS	KK	RB	MMK
P00	10/08/2023	PRELIMINARY	KK	RB	MMK



PROJECT: **LETTERKENNY ACTIVE TRAVEL**
SCHEME: **SCHEME 6**

DRAWING TITLE: **GENERAL ARRANGEMENT
KILMACRENNAN ROAD
SHEET 1 OF 2**

PURPOSE OF ISSUE: PRELIMINARY	STATUS/AVAILABILITY: S3 - SUITABLE FOR REVIEW AND COMMENT
DATE: 10/08/2023	SCALE: 1:500
DRAWING NUMBER: LKAT-CCC-GA-L06-DR-C-0001	SHEET SIZE: A1
	REVISION: P03

PRELIMINARY DESIGN

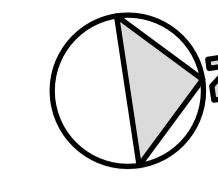

NOTES

- This drawing is the property of Clandillon Civil Consulting. This drawing should not be relied on or used in circumstances other than those for which it was originally prepared and for which Clandillon Civil Consulting was commissioned.
- All dimensions are in meters unless otherwise specified.

LEGEND

- BOUNDARY LINE
- ROAD CENTRELINE
- ROAD EDGE
- RAMP OUTLINE
- ADDITIONAL LAND REQUIREMENT
- 2 WAY RAISED CYCLE LANE
- 1 WAY CYCLE TRACK
- ON-ROAD CYCLE LANE
- SHARED USE PEDESTRIAN AND CYCLISTS FACILITY
- NEW / UPGRADED FOOTPATH
- EXISTING FOOTPATH TO BE RETAINED
- CONCRETE SHARED SURFACE
- BUS SET DOWN AREA
- GRASSED AREA
- SIDEROAD PAVEMENT
- ENTRANCE RAMP ADJUSTED TO FOOTWAY LEVEL
- MAINLINE CARRIAGEWAY PAVEMENT
- PAVED ISLAND/MEDIAN AREA
- OVERRUN AREA WITH ROUGHENED SURFACE
- ENTRANCE RAMP KERB
- RETAINING WALL
- CONTROLLED CROSSING TACTILE
- UNCONTROLLED CROSSING TACTILE
- CORDUROY PAVING
- CYCLISTS PARKING AREA
- BENCH
- EXISTING TREE TO BE REPLANTED
- EXISTING GRASS TO BE RETAINED

KEY PLAN

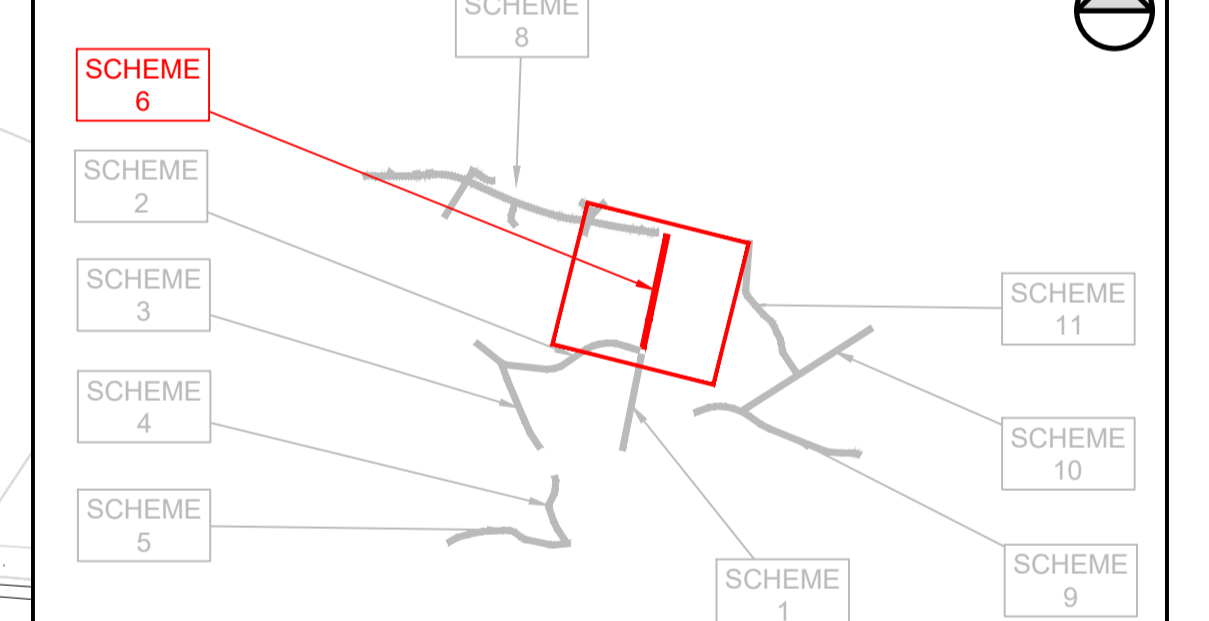

REV	DATE	DESCRIPTION	BY	CHK	APD
P03	30/11/2023	PRELIMINARY - CHANGES AS PER DCC COMMENTS	YC	RB	MMK
P02	31/10/2023	PRELIMINARY - CHANGES AS PER DCC COMMENTS	YC	RB	MMK
P01	03/10/2023	PRELIMINARY - CHANGES AS PER DCC COMMENTS	KK	RB	MMK
P00	10/08/2023	PRELIMINARY	KK	RB	MMK



CLANDILLON
 CIVIL CONSULTING

Comhairle Contae Dhún na nGall
 Donegal County Council

PROJECT: **LETTERKENNY ACTIVE TRAVEL**
SCHEME: **SCHEME 6**

DRAWING TITLE: **GENERAL ARRANGEMENT
KILMACRENAN ROAD
SHEET 2 OF 2**

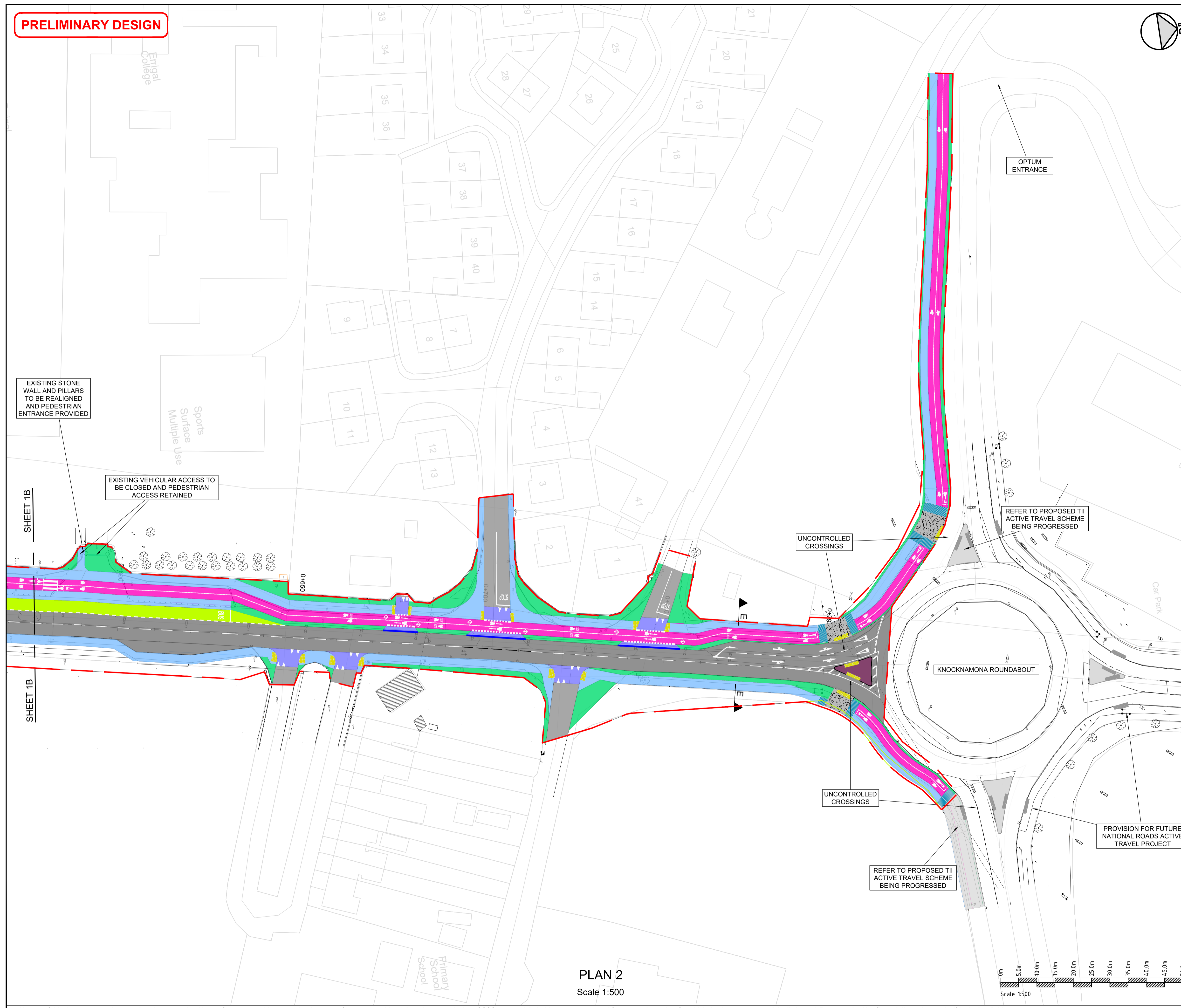
PURPOSE OF ISSUE: PRELIMINARY	STATUS/SUITABILITY: S3 - SUITABLE FOR REVIEW AND COMMENT
DATE: 10/08/2023	SCALE: 1:500
DRAWING NUMBER: LKAT-CCC-GA-L06-DR-C-0002	SHEET SIZE: A1
	REVISION: P03



PLAN 2
Scale 1:500

No part of this document may be reproduced or transmitted in any form or stored in any retrieval system of any nature without the written permission of CCC as copyright holder except as agreed for use on the project for which the document was originally issued. Do not scale. Use figured dimensions only. If in doubt - Ask!

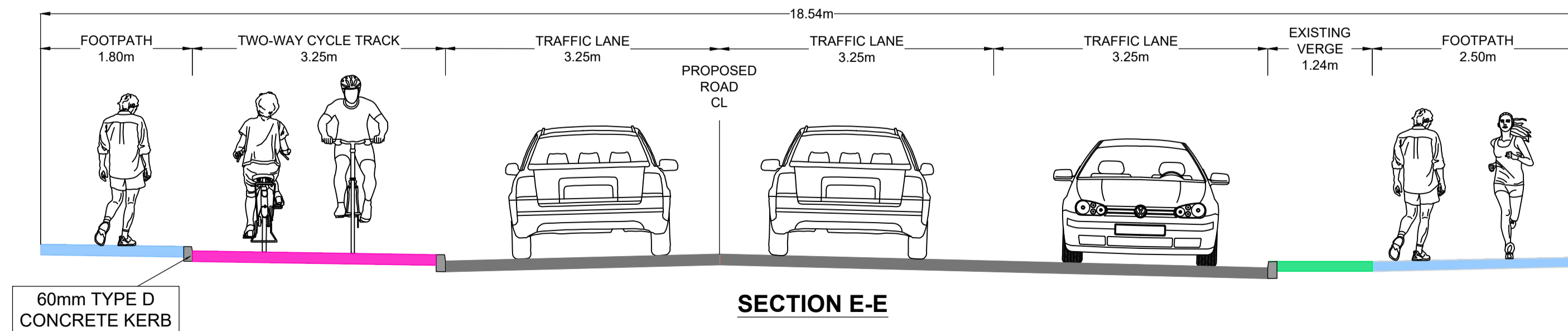
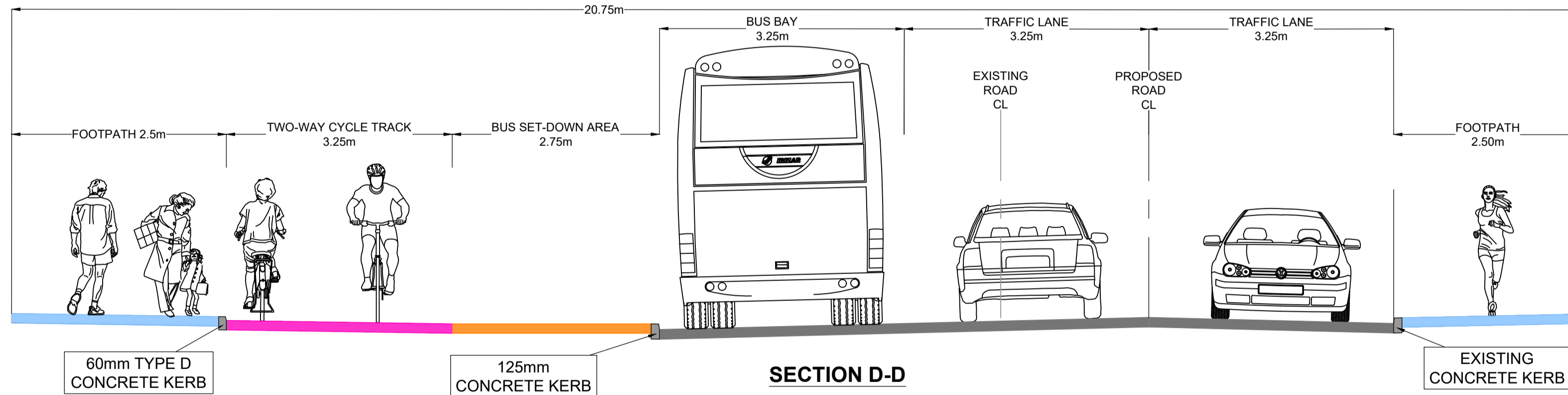
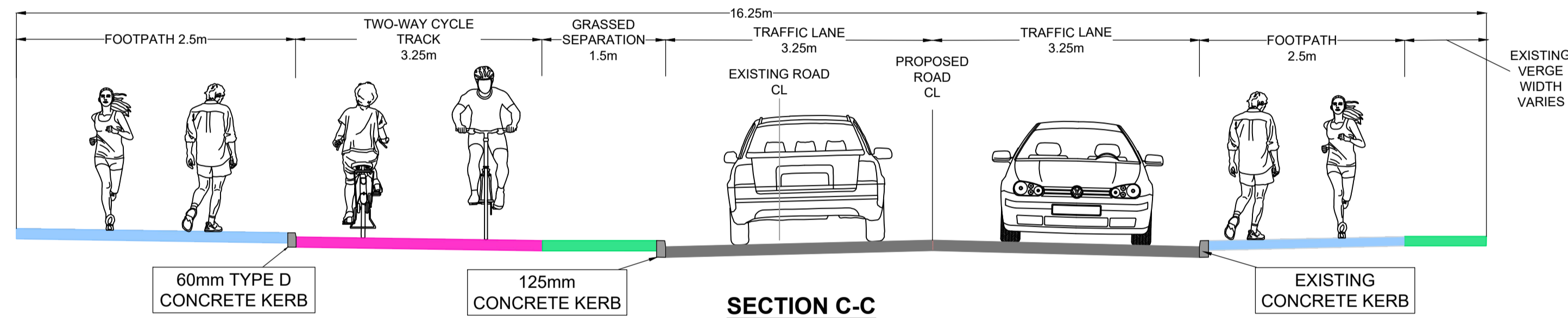
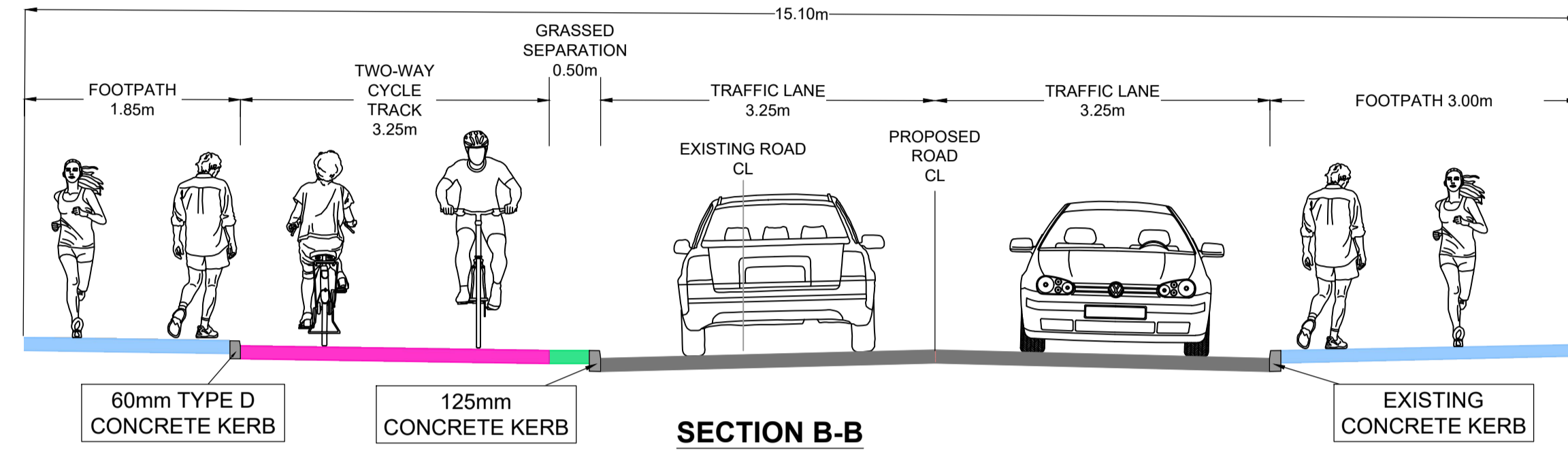
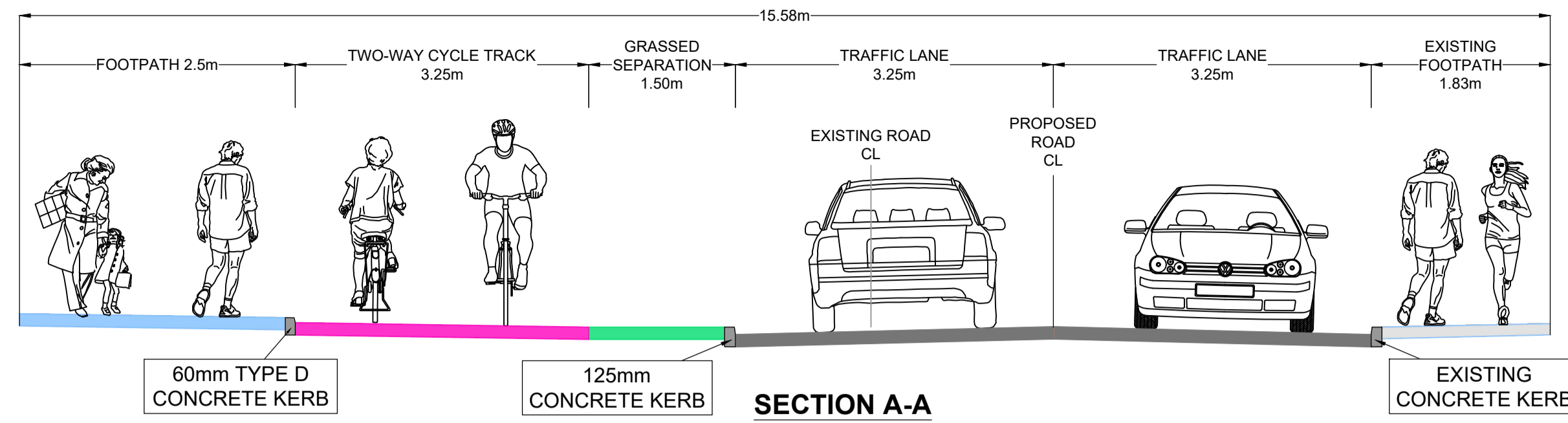

PLAN

Scale 1:50

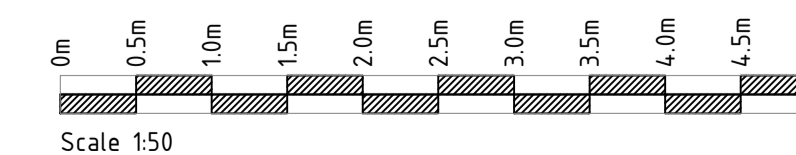

NOTES

1. This drawing is the property of Clandillon Civil Consulting. This drawing should not be relied on or used in circumstances other than those for which it was originally prepared and for which Clandillon Civil Consulting was commissioned.
2. All dimensions are in meters unless otherwise specified.
3. Proposed cross section options are based on OS Mapping.

LEGEND

- ROAD SURFACE
- GRASSED SEPARATION
- TWO WAY CYCLE TRACK
- PROPOSED FOOTPATH
- EXISTING FOOTPATH TO BE RETAINED
- BUS SET DOWN AREA

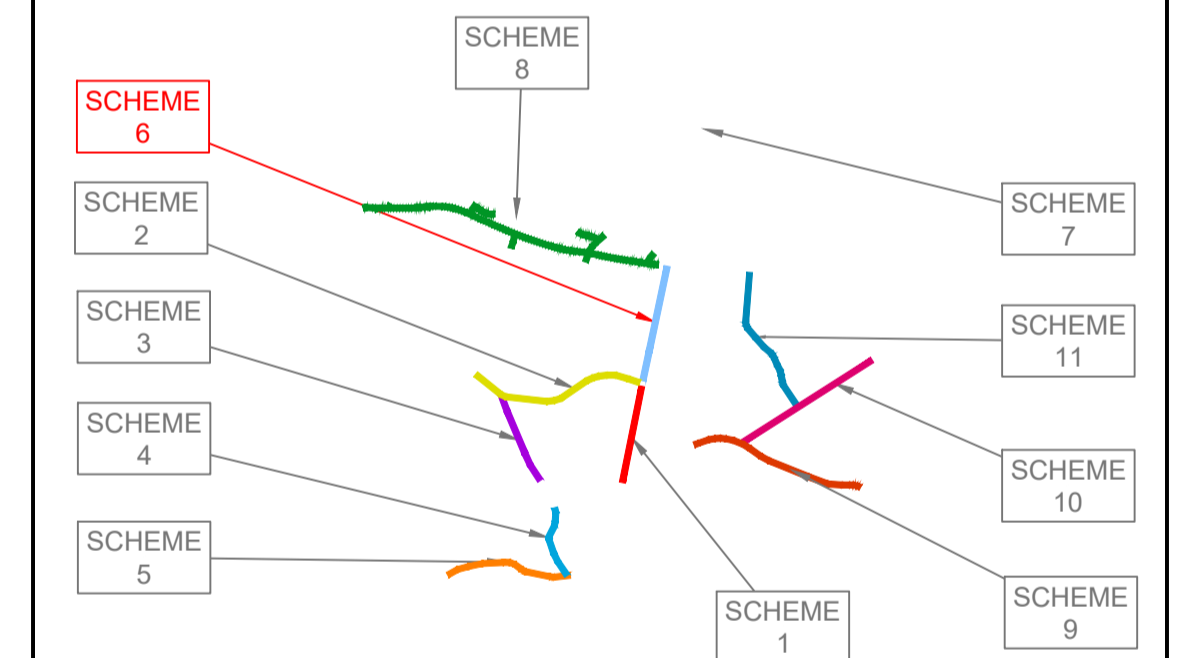

REV	DATE	DESCRIPTION	BY	CHK	APD
P00	03/10/2023	PRELIMINARY	RMC	MMK	SC
P00	01/09/2023	PRELIMINARY	ZM	RB	SC

CONSULTANT

CLIENT

PROJECT **LETTERKENNY ACTIVE TRAVEL**

SCHEME **SCHEME 6 -**

DRAWING TITLE **TYPICAL CROSS SECTIONS SCHEME 06**

PURPOSE OF ISSUE	STATUS/SUBMITTAL	SHEET SIZE
PRELIMINARY	FOR REVIEW AND COMMENTS	A1
DATE	SCALE	REVISION
01/09/2023	1:50	
DRAWING NUMBER		
LKAT-CCC-XS-L06-DR-C-0101		P01