

Detailed Design Application For Cooper's Road Active Travel Scheme July 2023

Date: July 2023

Issue: Preliminary Design

Revision: A

Employer:

Donegal County Council
County House,
Lifford,
County Donegal,
F93 Y622

Phone: (074) 91 53900

Email: info@donegalcoco.ie

Prepared By:

TOBIN Consulting Engineers
Fairgreen House
Fairgreen Road
Galway
H91 AXK8

Phone: (091) 565 211

Email: galway@tobin.ie

TOBIN
CONSULTING ENGINEERS



An Roinn Iompair
Department of Transport

Detailed Design Application For Cooper's Road Active Travel Scheme July 2023

Schedule of Drawings

<u>DRAWING NO.</u>	<u>TITLE</u>	<u>REVISION NO.</u>
11493-03-002	Site Location	A
11493-03-003	Existing Layout	A
11493-03-004	Proposed Layout	A
11493-03-005	Preliminary Design Details	A

**SITE LOCATION
Milford**

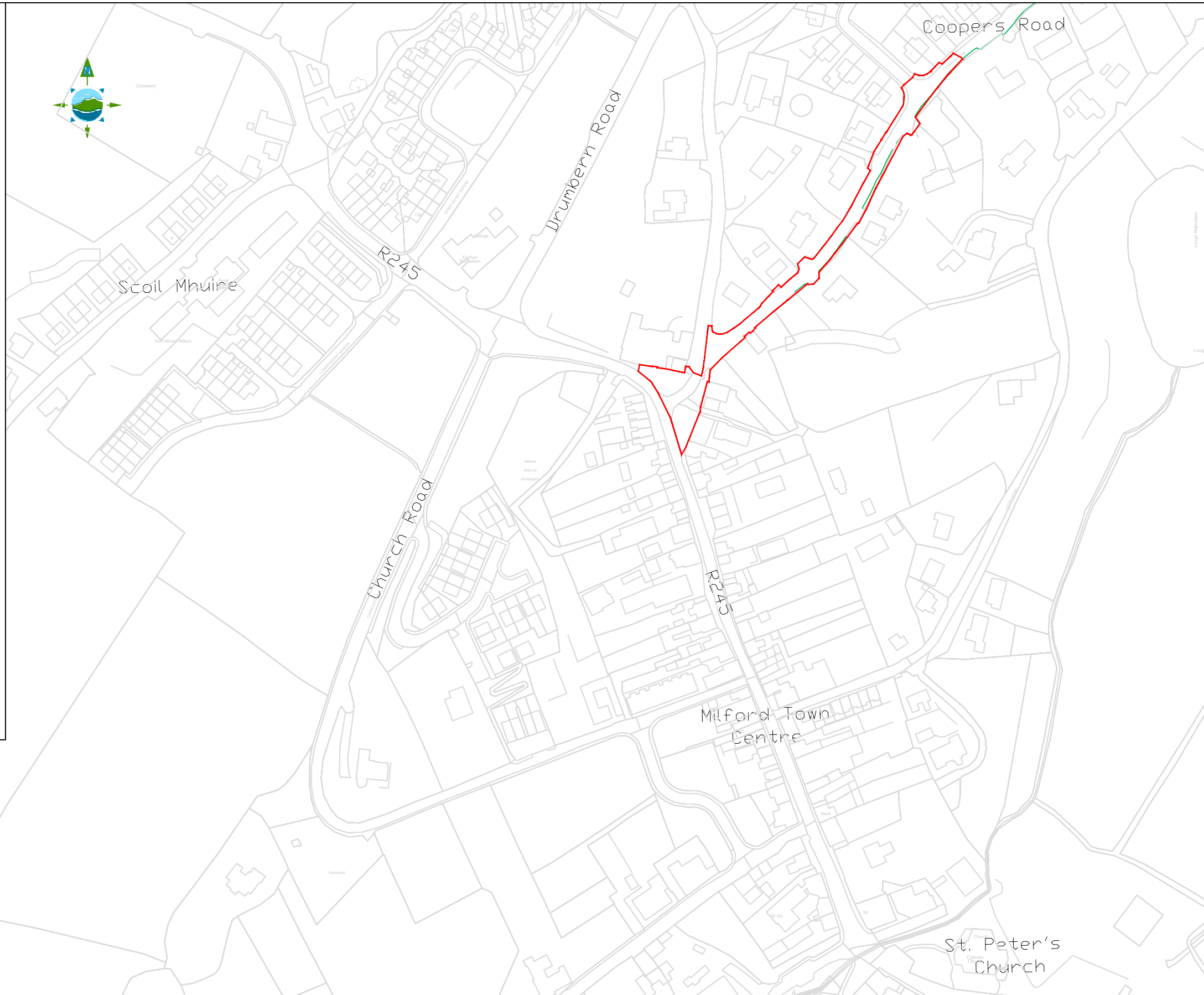
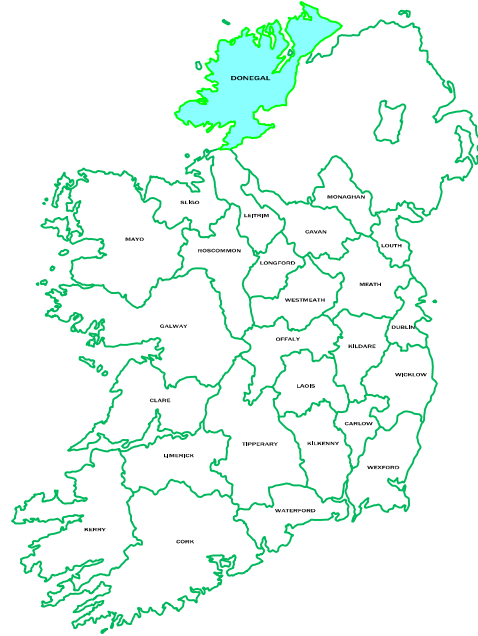

LEGEND:

- Scheme Extents
- Background Mapping
- Survey

Rev	Date	Description	By	Chkd.

Client: 
Donegal County Council

Project: **Countywide Active Travel
L-1253 Coopers Road, Milford**

Title: **Preliminary Design
Site Location Map**

Prepared by: **CQ**

Checked: **RF**

Date: **July 2023**

Project Director:
John O'Flaherty

Drawing Status:
Planning

Scale @ A1:
1:2500

TOBIN
CONSULTING ENGINEERS

TOBIN Consulting Engineers,
Market Square, Castlebar,
Co. Mayo, Ireland.
tel: +353-(0)94-9021401
fax: +353-(0)94-9021534
e-mail: castlebar@tobin.ie
www.tobin.ie

TOBIN Consulting Engineers will not be liable for any use of this document for any purpose other than that for which it was originally prepared and provided. Except where specifically and explicitly agreed in writing by TOBIN Consulting Engineers, as copyright holder, no part of this document may be reproduced or transmitted in any form and this document shall not be relied upon by any third party for any purpose.

Drawing No.: **11493-03-002**

Revision:
REV A

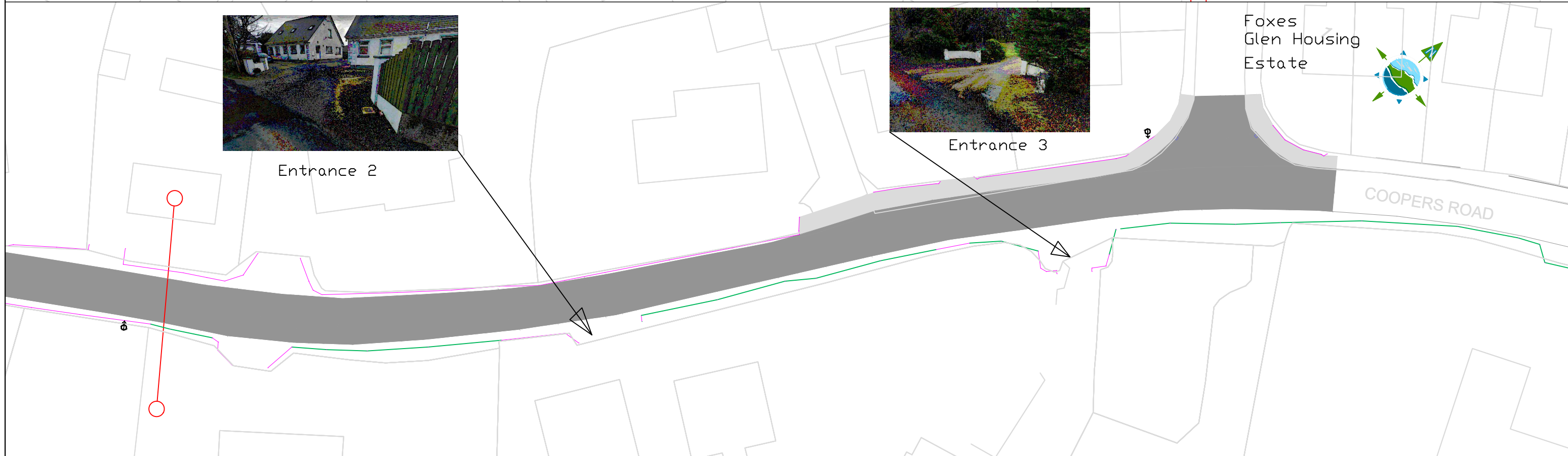
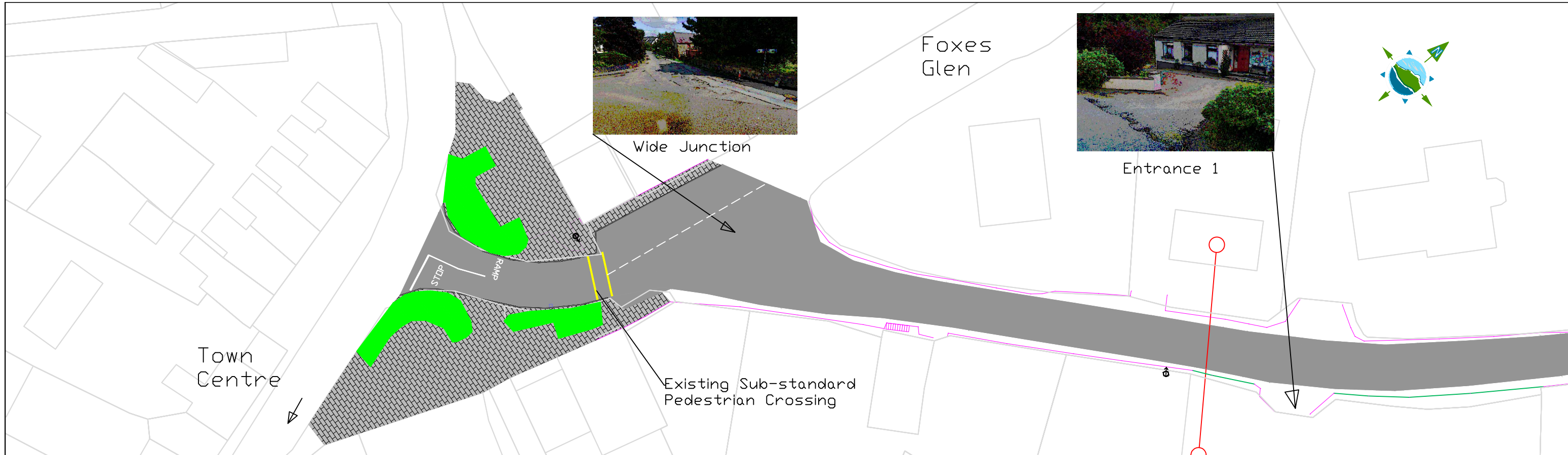

- LEGEND:**
- Existing Footpath
 - Pavement Main Road
 - Existing Decorative Pavement
 - Road Edge
 - Existing Planters
 - Walls
 - Background Mapping
 - Existing Lighting
 - Fence / Ditch

Rev	Date	Description	By	Chkd.

Client: Donegal County Council

Project: Countywide Active Travel
L-1253 Coopers Road, Milford

Title: Preliminary Design
Existing Layout

Prepared by: CQ

Checked: RF

Date: July 2023

Project Director: John O'Flaherty

Drawing Status: Planning

Scale @ A1: 1:1000

TOBIN CONSULTING ENGINEERS

TOBIN Consulting Engineers, Market Square, Castlebar, Co. Mayo, Ireland.
tel: +353-(0)94-9021401
fax: +353-(0)94-9021534
e-mail: castlebar@tobin.ie
www.tobin.ie

TOBIN Consulting Engineers will not be liable for any use of this document for any purpose other than that for which it was originally prepared and provided. Except where specifically and explicitly agreed in writing by TOBIN Consulting Engineers, as copyright holder, no part of this document may be reproduced or transmitted in any form and this document shall not be relied upon by any third party for any purpose.

Drawing No.: **11493-03-003**

Revision: **REV A**

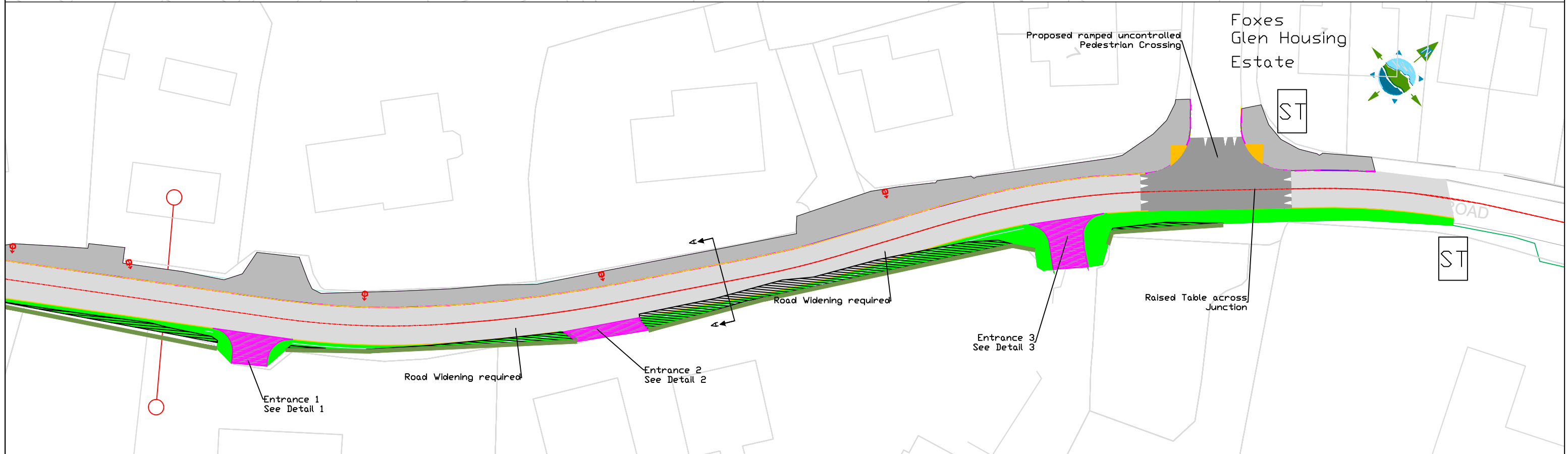
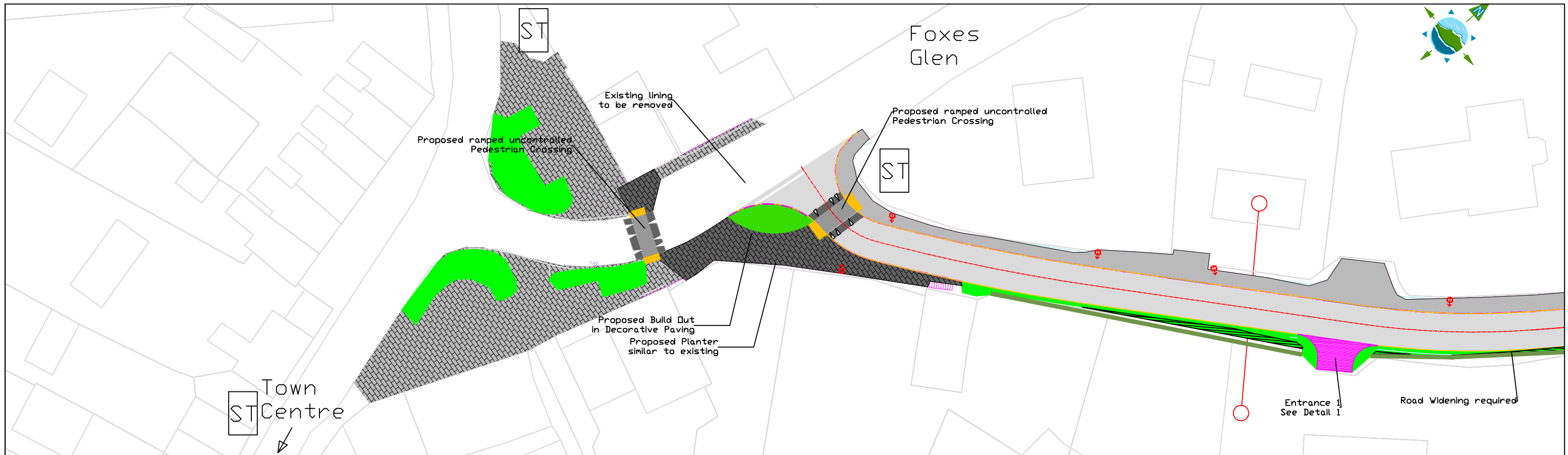

- LEGEND:**
- Proposed Concrete Footpath
 - Proposed Decorative Paving Footpath
 - Pavement main road
 - Proposed Grass Verge
 - Proposed Land Take
 - Proposed Accommodation Works
 - Proposed Public Lighting Column
 - Site Notice
 - Proposed Wall
 - Proposed Kerb - Full Height 125mm
 - Proposed Kerb - Drop Kerb
 - Proposed Tactile Paving
 - Road Marking - Line
 - Background Mapping
 - Topographical Survey

Rev	Date	Description	By	Chkd.

Client: Donegal County Council

Project: Countywide Active Travel
L-1253 Coopers Road, Milford

Title: Preliminary Design
Proposed Layout

Prepared by: CQ

Checked: RF

Date: July 2023

Project Director: John O'Flaherty

Drawing Status: Planning

Scale @ A1: 1:1000

TOBIN
CONSULTING ENGINEERS

TOBIN Consulting Engineers,
Market Square, Castlebar,
Co. Mayo, Ireland.
tel: +353-(0)94-9021401
fax: +353-(0)94-9021534
e-mail: castlebar@tobin.ie
www.tobin.ie

TOBIN Consulting Engineers will not be liable for any use of this document for any purpose other than that for which it was originally prepared and provided. Except where specifically and explicitly agreed in writing by TOBIN Consulting Engineers, as copyright holder, no part of this document may be reproduced or transmitted in any form and this document shall not be relied upon by any third party for any purpose.

Drawing No.: **11493-03-004**

Revision: **REV A**

Scale 1:250
Detail 1

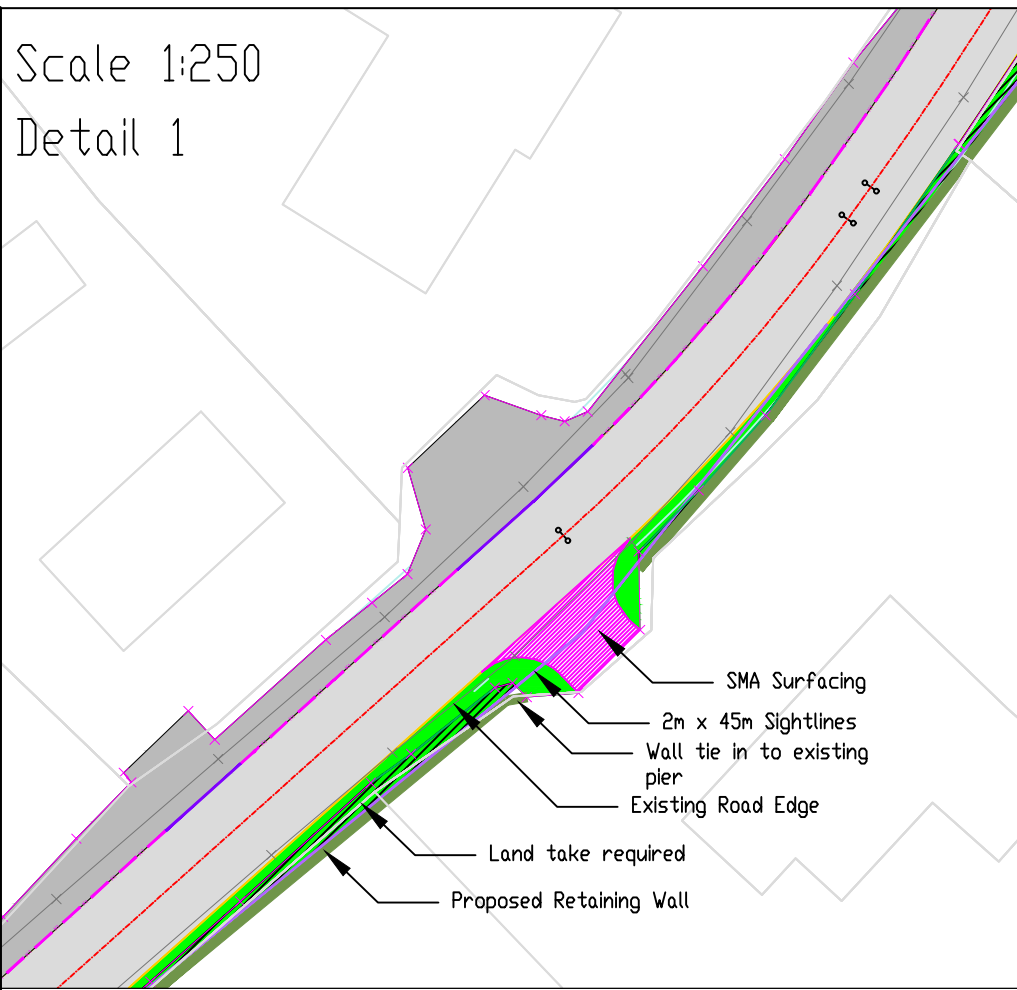

- LEGEND:
- Proposed Concrete Footpath
 - Proposed Decorative Paving Footpath
 - Pavement main road
 - Proposed Grass Verge
 - Proposed Land Take
 - Proposed Accommodation Works
 - Proposed Wall
 - Proposed Kerb - Full Height 125mm
 - Proposed Kerb - Drop Kerb
 - Proposed Tactile Paving
 - Road Marking - Line
 - Background Mapping
 - Topographical Survey

Scale 1:250
Detail 2

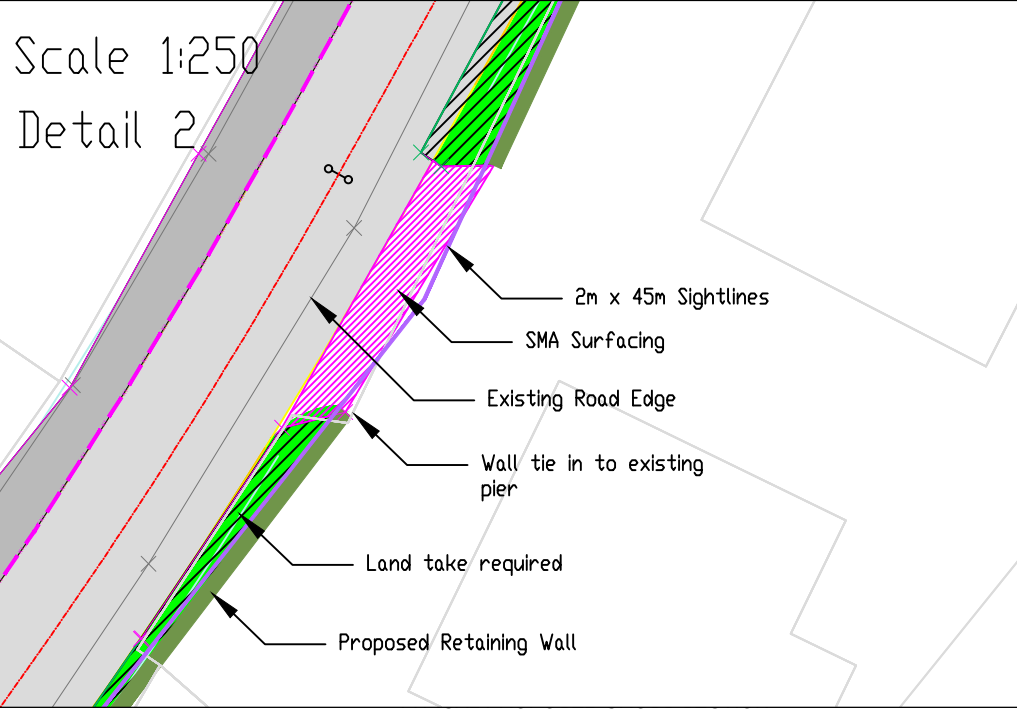

Scale 1:250
Detail 3

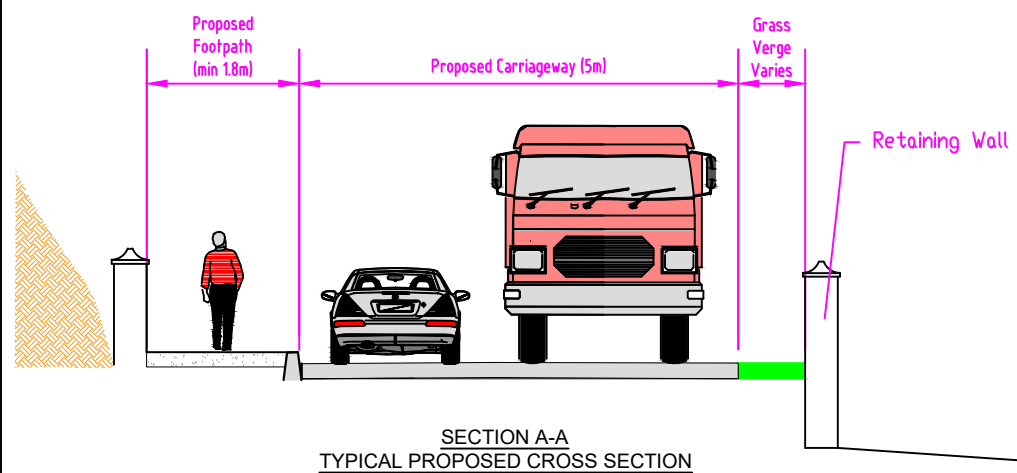

NTS

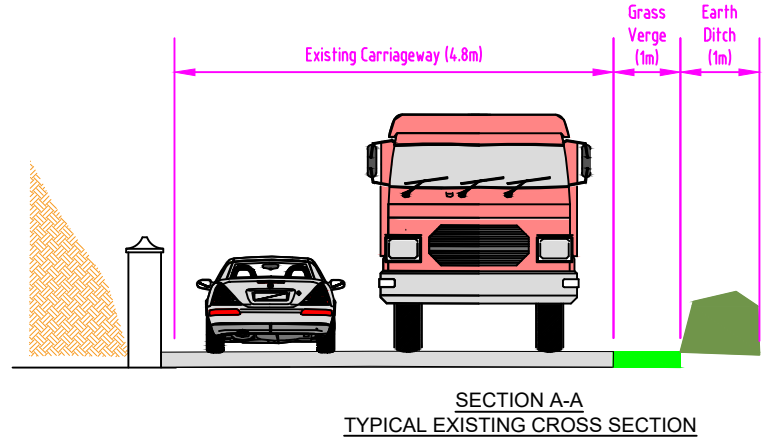

NTS



NTS

Rev	Date	Description	By	Chkd.

Client: Donegal County Council

Project: Countywide Active Travel
L-1253 Coopers Road, Milford

Title: Preliminary Design
Details

Prepared by: CQ

Checked: RF

Date: July 2023

Project Director: John O'Flaherty

Drawing Status: Planning

Scale @ A1: As Shown

TOBIN
CONSULTING ENGINEERS

TOBIN Consulting Engineers,
Market Square, Castlebar,
Co. Mayo, Ireland.
tel: +353-(0)94-9021401
fax: +353-(0)94-9021534
e-mail: castlebar@tobin.ie
www.tobin.ie

TOBIN Consulting Engineers will not be liable for any use of this document for any purpose other than that for which it was originally prepared and provided. Except where specifically and explicitly agreed in writing by TOBIN Consulting Engineers, as copyright holder, no part of this document may be reproduced or transmitted in any form and this document shall not be relied upon by any third party for any purpose.

Drawing No.: **11493-03-005**

Revision: **REV A**